



INDICATIVE PHOTO

General features : RDF3250

RDF range unit coolers have been designed to be installed inside cold rooms suited for fresh and frozen goods storage

The main feature of this range is of throwing air from both sides; this allow the unit cooler to be placed in the middle of the cold room ceiling giving a uniform air flow and, as a result, the best product conservation

RDF range is available in two different fan diameters and three types of fin spacing according to the needed application

The ED version is supplied with mounted defrosting heaters and is suitable for being used at low temperature applications

The range consists of two types of coils , both made of aluminium fins and copper tube: 3/8" tube size with a geomet

The model types having 250 mm fan diameter are fitted with a coil of 4,5 mm / 9 mm fin spacing, suited for applications with a cold room temperature (Tc) from -30°C to +10°C

The coils are tested with nitrogen at a pressure of 25 bar.

The fan motor models in use have the following features:

Manufactured following EN 60335-1 laws, with internal thermal protection

Fan diameter 250mm

Power supply 230-240V/1/50-60Hz

IP42 protection rate

Operating temperature from -40°C to +40°C

B insulation class

Electrics made in conformity with 2006/95/CE Low Tension directive

The housing is made of aluminium

The manufacturing solutions used give the housing strength and guarantee the absence of vibrations during the functioning.

Screws, washers and nuts are made of stainless steel



INDICATIVE PHOTO

Product file : Unit coolers

Code	RDF3250ED
Model	Ceiling unit c. dual air flow
Range	RDF
Application	MBP
Net weight	28,9 kg
Inlet connection	12 mm - 1/2" SAE
Outlet connection	18 mm
Drain connection	1" Gas (33mm)
Ped	0
Rows	4
Fin spacing	4,5 / 9
Circuit volume	3,73 dm ³
Total surface	12,6 m ²

Fan motor

Type	AC
Fans no.	3
Diameter	254 mm
Power supply	220-240/1/50-60
Defrost	2500 W
Speed	1300 rpm
Power consumption	180 W
Current consumption	1,5 A
Air flow	1621 m ³ /h
Air throw	2x8 m

Technical drawing - RDF3250

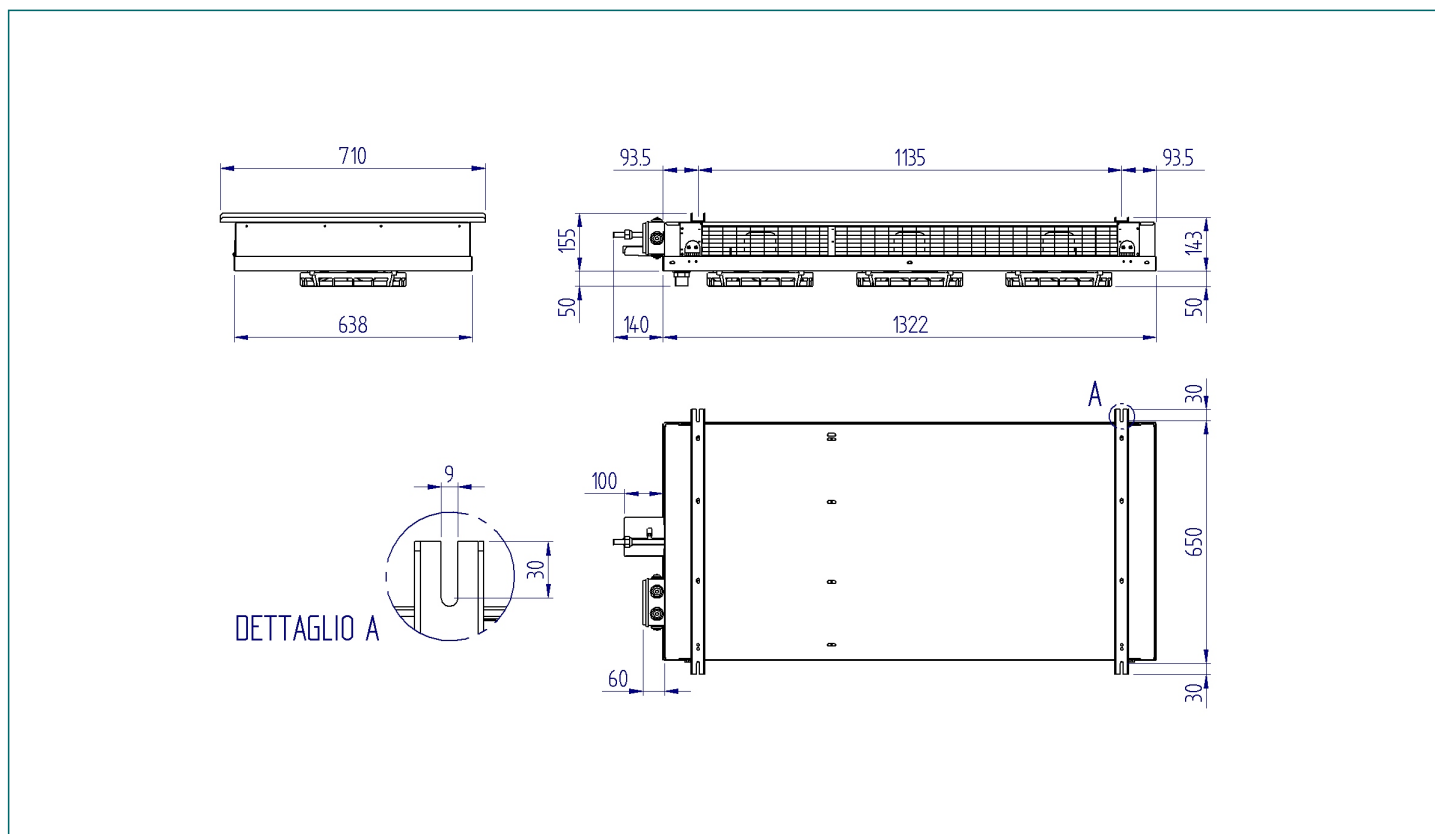

Refrigerating capacity table (watt) - Gas :

dT \ Tc	-40°C	-35°C	-30°C	-25°C	-20°C	-15°C	-10°C	-5°C	0°C	2°C	4°C	6°C	8°C	10°C	12°C	15°C
10	1690 ⁽¹⁾	1970	2290	2600	2850	3060	3300	3550	3840	3910	3990	4050	4120	4220	4360	4570
9	1590 ⁽¹⁾	1860 ⁽¹⁾	2140	2380	2620	2800	3000	3220	3480	3550	3610	3660	3720	3850	3960	4125
8	1490 ⁽¹⁾	1730 ⁽¹⁾	1970	2170	2340	2510	2680	2880	3110	3160	3210	3250	3320	3440	3540	3690
7	1360 ⁽¹⁾	1570 ⁽¹⁾	1780	1930	2060	2200	2350	2520	2720	2760	2790	2850	2920	3010	3110	3260
6	1220 ⁽¹⁾	1390 ⁽¹⁾	1540	1670	1770	1890	2010	2160	2350	2390	2440	2490	2540	2630	2720	2855
5	1060 ⁽¹⁾	1190 ⁽¹⁾	1290	1370	1460	1550	1660	1790	1950	1980	2020	2070	2140	2220	2310	2445

(1) Applicazione fuori dal campo consigliato