



INDICATIVE PHOTO

General features : RDF2250

RDF range unit coolers have been designed to be installed inside cold rooms suited for fresh and frozen goods storage

The main feature of this range is of throwing air from both sides; this allow the unit cooler to be placed in the middle of the cold room ceiling giving a uniform air flow and, as a result, the best product conservation

RDF range is available in two different fan diameters and three types of fin spacing according to the needed application

The ED version is supplied with mounted defrosting heaters and is suitable for being used at low temperature applications

The range consists of two types of coils , both made of aluminium fins and copper tube: 3/8" tube size with a geomet

The model types having 250 mm fan diameter are fitted with a coil of 4,5 mm / 9 mm fin spacing, suited for applications with a cold room temperature (Tc) from -30°C to +10°C

The coils are tested with nitrogen at a pressure of 25 bar.

The fan motor models in use have the following features:

Manufactured following EN 60335-1 laws, with internal thermal protection

Fan diameter 250mm

Power supply 230-240V/1/50-60Hz

IP42 protection rate

Operating temperature from -40°C to +40°C

B insulation class

Electrics made in conformity with 2006/95/CE Low Tension directive

The housing is made of aluminium

The manufacturing solutions used give the housing strength and guarantee the absence of vibrations during the functioning.

Screws, washers and nuts are made of stainless steel



INDICATIVE PHOTO

Product file : Unit coolers

Code	RDF2250ED
Model	Ceiling unit c. dual air flow
Range	RDF
Application	MBP
Net weight	19,2 kg
Inlet connection	10 mm - 1/2" SAE
Outlet connection	12 mm
Drain connection	1/2" Gas (20mm)
Ped	0
Rows	4
Fin spacing	4,5 / 9
Circuit volume	2,42 dm ³
Total surface	8,07 m ²

Fan motor

Type	AC
Fans no.	2
Diameter	254 mm
Power supply	220-240/1/50-60
Defrost	1650 W
Speed	1300 rpm
Power consumption	120 W
Current consumption	1 A
Air flow	1052 m ³ /h
Air throw	2x4 m

Technical drawing - RDF2250

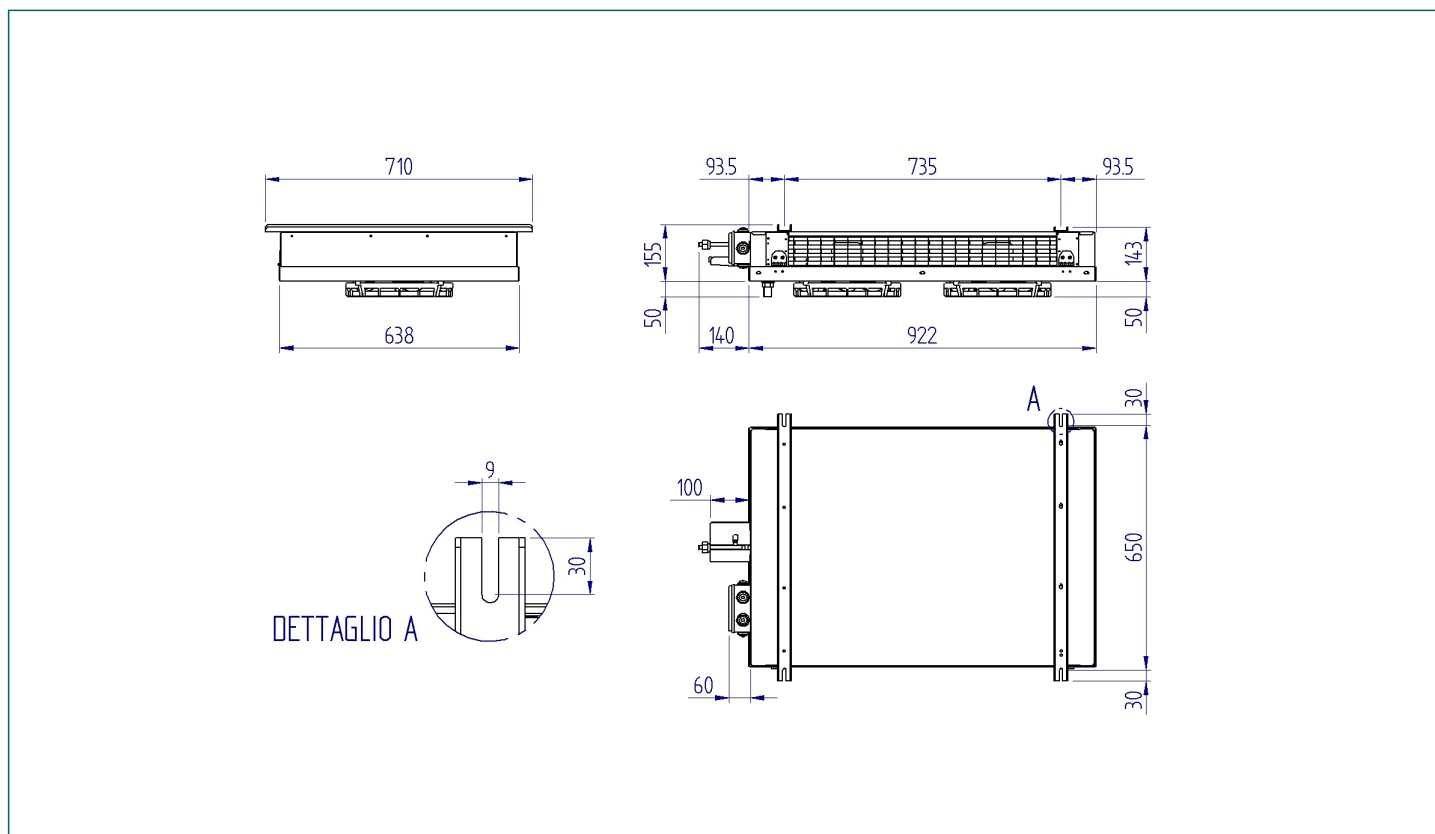

Refrigerating capacity table (watt) - Gas :

dT \ Tc	-40°C	-35°C	-30°C	-25°C	-20°C	-15°C	-10°C	-5°C	0°C	2°C	4°C	6°C	8°C	10°C	12°C	15°C
10	786 ⁽¹⁾	942 ⁽¹⁾	1130	1340	1530	1730	1890	2080	2280	2350	2400	2460	2510	2600	2690	2825
9	750 ⁽¹⁾	900 ⁽¹⁾	1080	1260	1430	1600	1750	1910	2100	2150	2200	2250	2300	2390	2460	2565
8	709 ⁽¹⁾	850 ⁽¹⁾	1010	1170	1320	1450	1580	1730	1900	1940	1980	2020	2070	2150	2230	2350
7	661 ⁽¹⁾	790 ⁽¹⁾	928	1060	1190	1290	1390	1530	1680	1710	1740	1780	1850	1910	1970	2060
6	605 ⁽¹⁾	719 ⁽¹⁾	834	944	1040	1110	1210	1320	1450	1470	1500	1530	1600	1660	1720	1810
5	538 ⁽¹⁾	630 ⁽¹⁾	721	807	875	937	1020	1110	1220	1240	1260	1310	1370	1420	1480	1570

(1) Applicazione fuori dal campo consigliato